

A detailed view of an elevator shaft's interior. The image shows a complex arrangement of steel cables, metal tracks, and support structures. The shaft walls are made of concrete, and the floor is also concrete. The lighting is bright, highlighting the metallic surfaces and the intricate engineering of the lift system. A semi-transparent white banner is overlaid across the center of the image, containing the text 'WORK SAFETY IN LIFT INDUSTRY'.

WORK SAFETY IN LIFT INDUSTRY

CONTENTS

1 ABOUT US

2 LIFT WORK CYCLE

3 ACCIDENT ANALYSIS

4 SAFE SYSTEM OF WORK &
CARDINAL RULES

5 WHAT ARE WE DOING?

ABOUT US

Presents the lift and escalator industry as a specialized profession and promotes international standards and expertise within the industry.

Consist of 11 lift companies as members, with 4 different functions of subcommittee in achieving the following objectives:

- The attainment of a consistently high standard of competence in the lift and escalator industry;
- The promotion and cultivation of safety in the lift and escalator industry;
- The provision of all necessary steps for the general advancement and improvement within the lift and escalator industry so as to serve better the public of Hong Kong;
- The representation of those engaged in the lift and escalator industry in Hong Kong in negotiations and discussions pertinent to the industry as a whole in Hong Kong;
- The furtherance of training in the lift and escalator industry; and
- The employment of the funds of the Association for the purposes and objects of the Association.



LOCAL REGULATIONS RELATED TO SAFETY ^④ OF LIFT SHAFT WORKS



Cap. 59
Factories and Industrial
Undertakings Ordinance
And its subsidiary regulations



Cap. 509
Occupational Safety
and Health Ordinance
And its subsidiary regulations



Cap. 618
Lifts and Escalators Ordinance
And its subsidiary regulations



Cap. 123 Buildings Ordinance
And its subsidiary regulations

CIC GUIDELINES ON SAFETY OF LIFT SHAFT WORKS

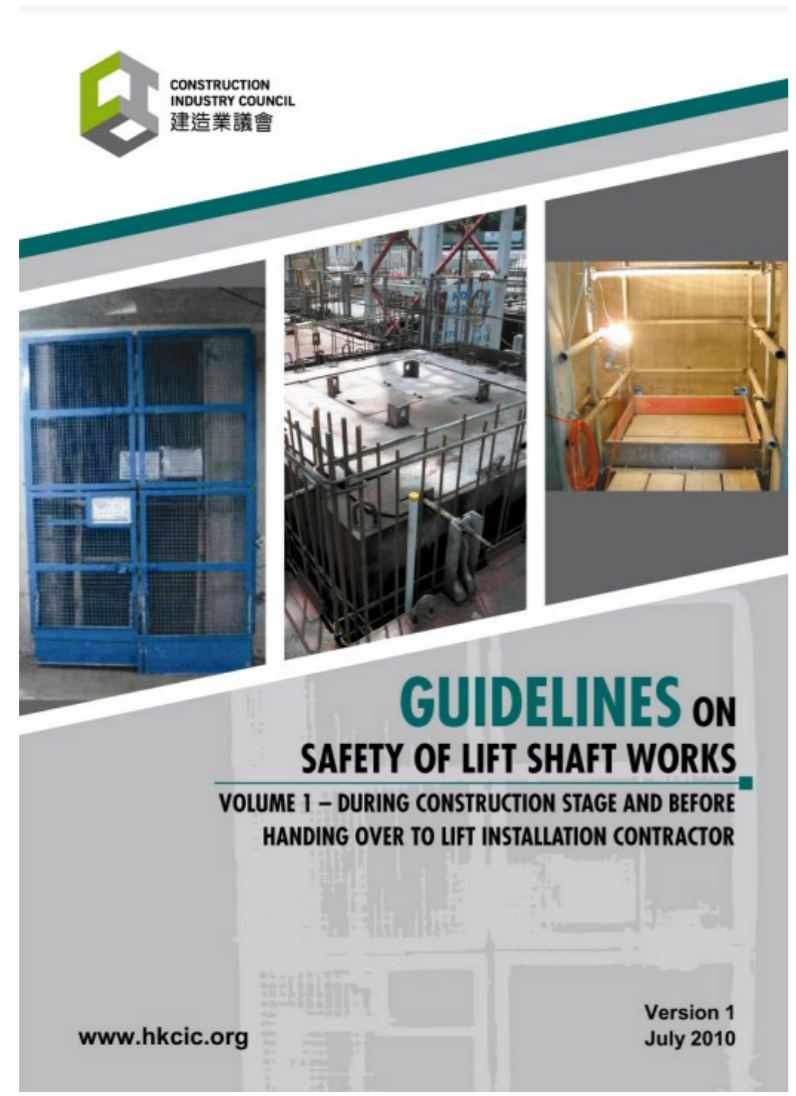

CONSTRUCTION STAGE
VOLUME 1

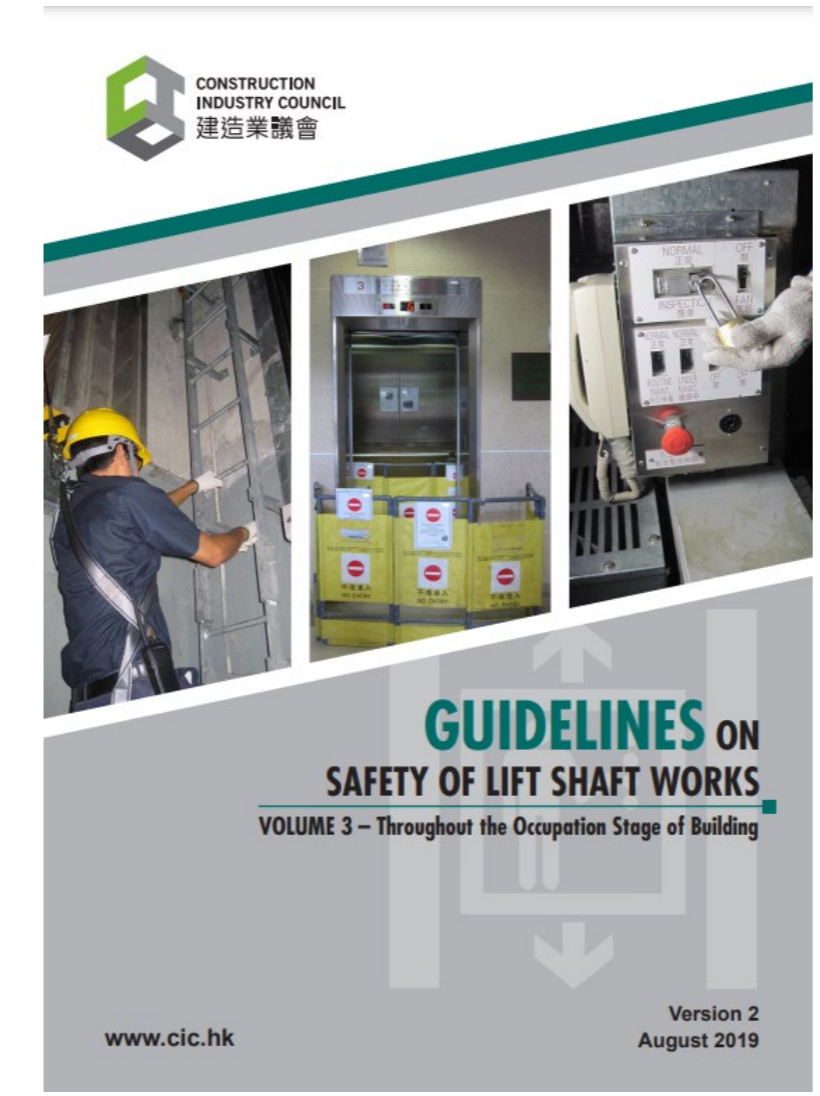

OPERATION STAGE OF BUILDING
VOLUME 3

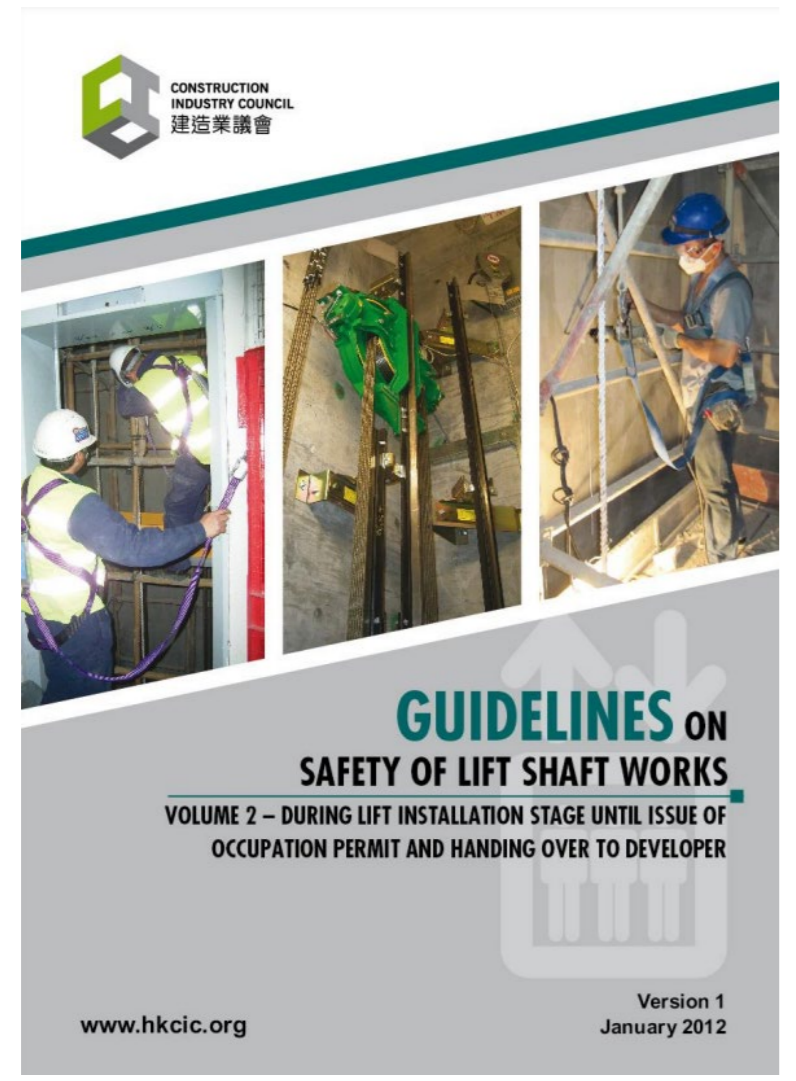

INSTALLATION STAGE
VOLUME 2

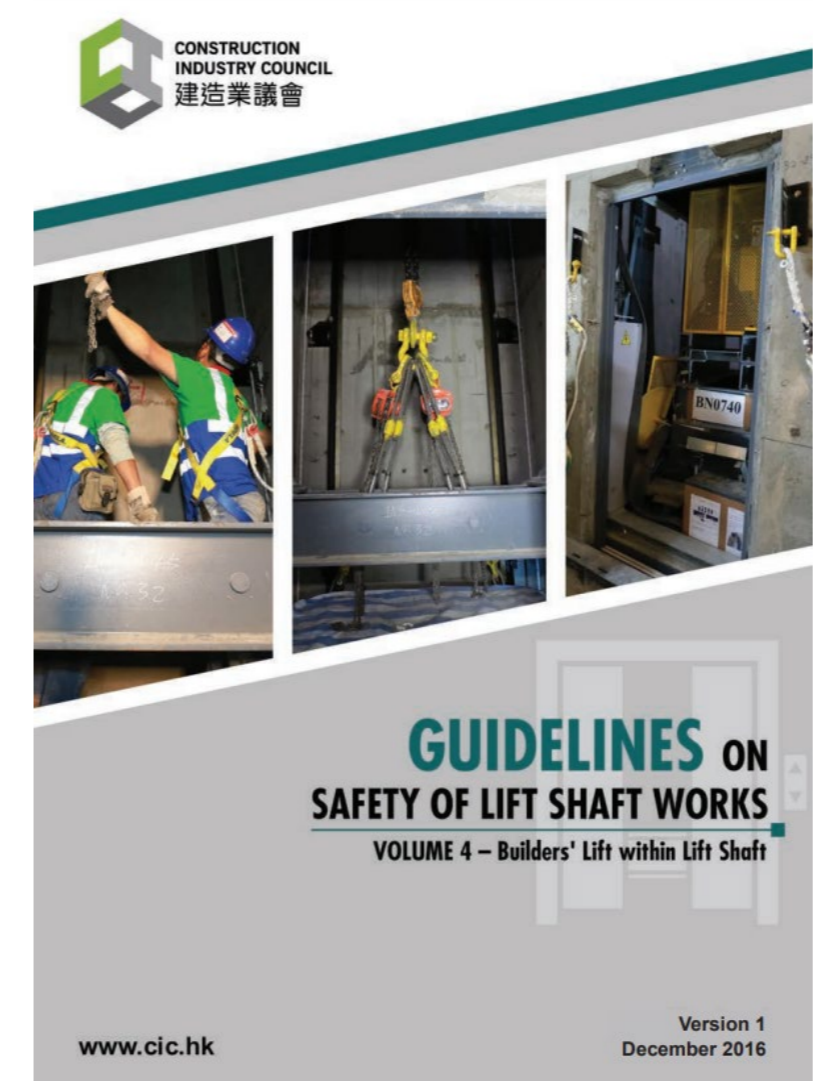

BUILDER'S LIFT
VOLUME 4

CONTENTS

1 ABOUT US

2 LIFT WORK CYCLE

3 ACCIDENT ANALYSIS

4 SAFE SYSTEM OF WORK &
CARDINAL RULES

5 WHAT ARE WE DOING?

LIFT WORK CYCLE

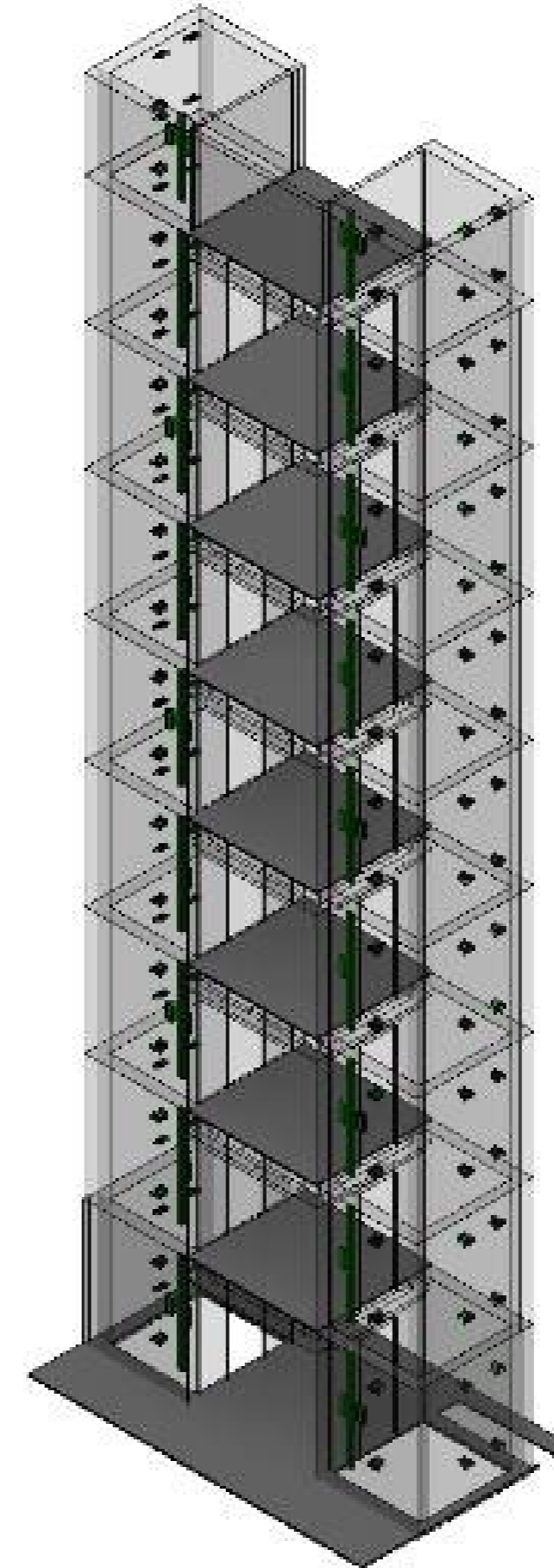

1

DESIGN

2

SHAFT CONSTRUCTION

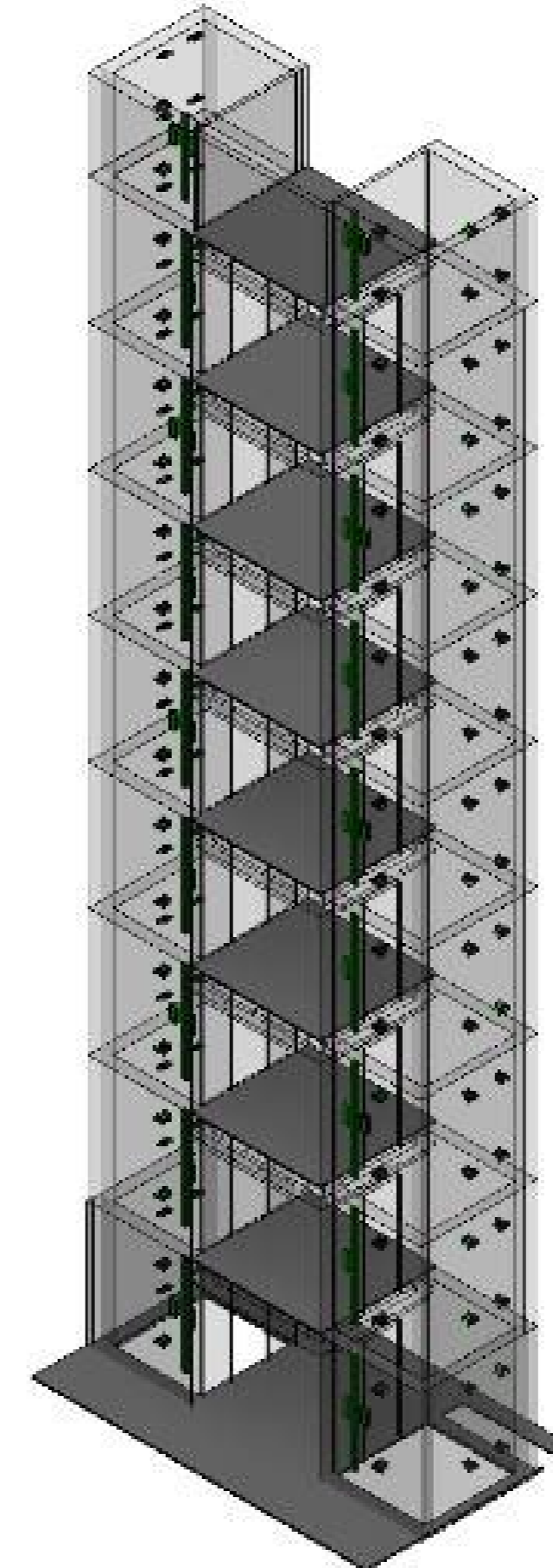

SHAFT CONSTRUCTION

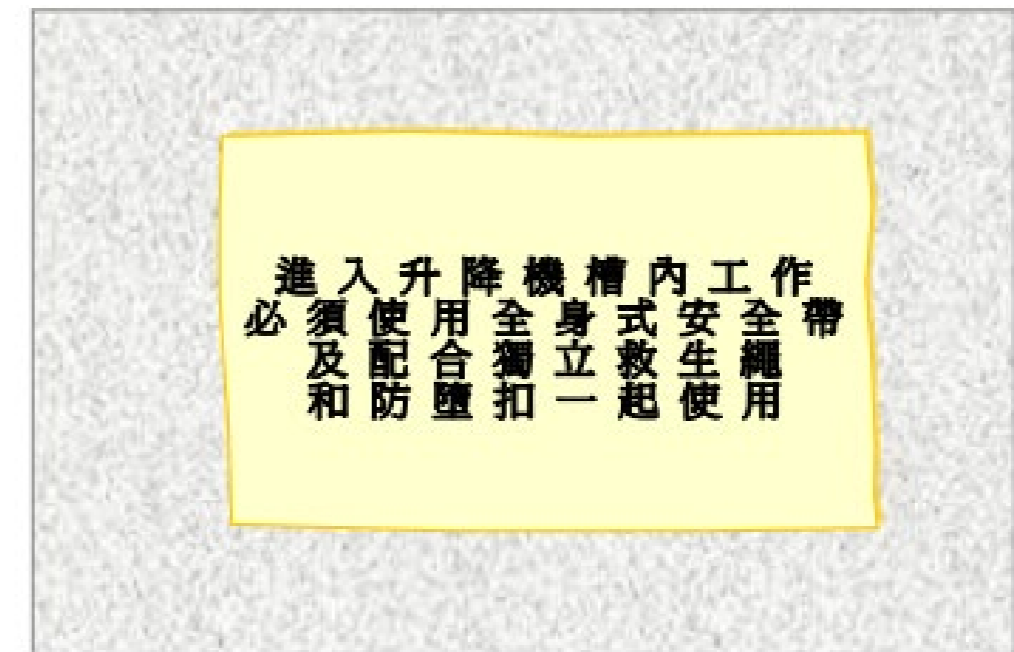
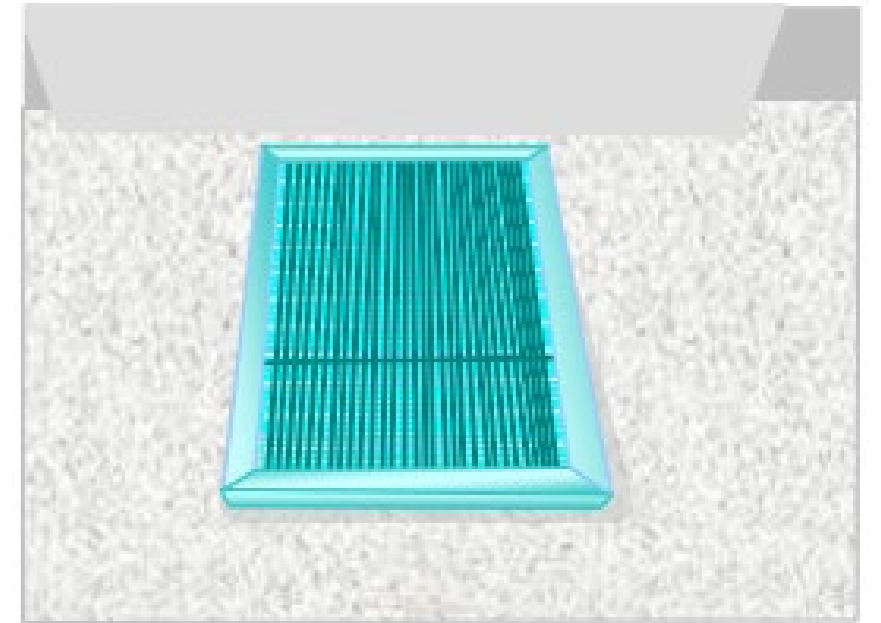
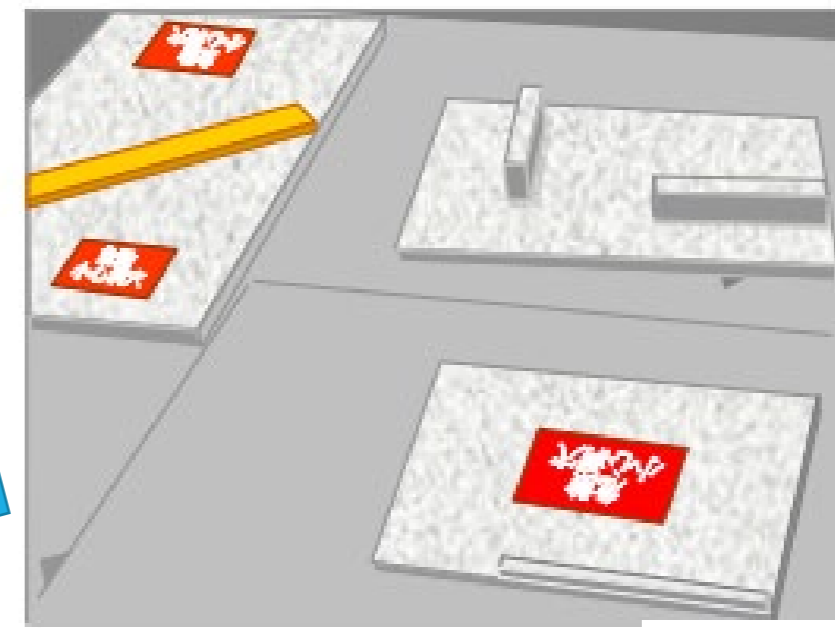
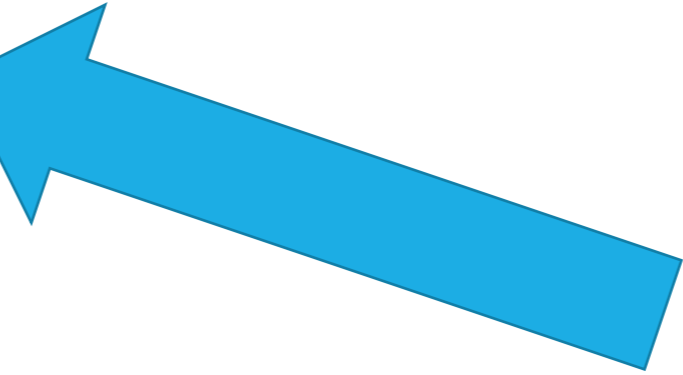
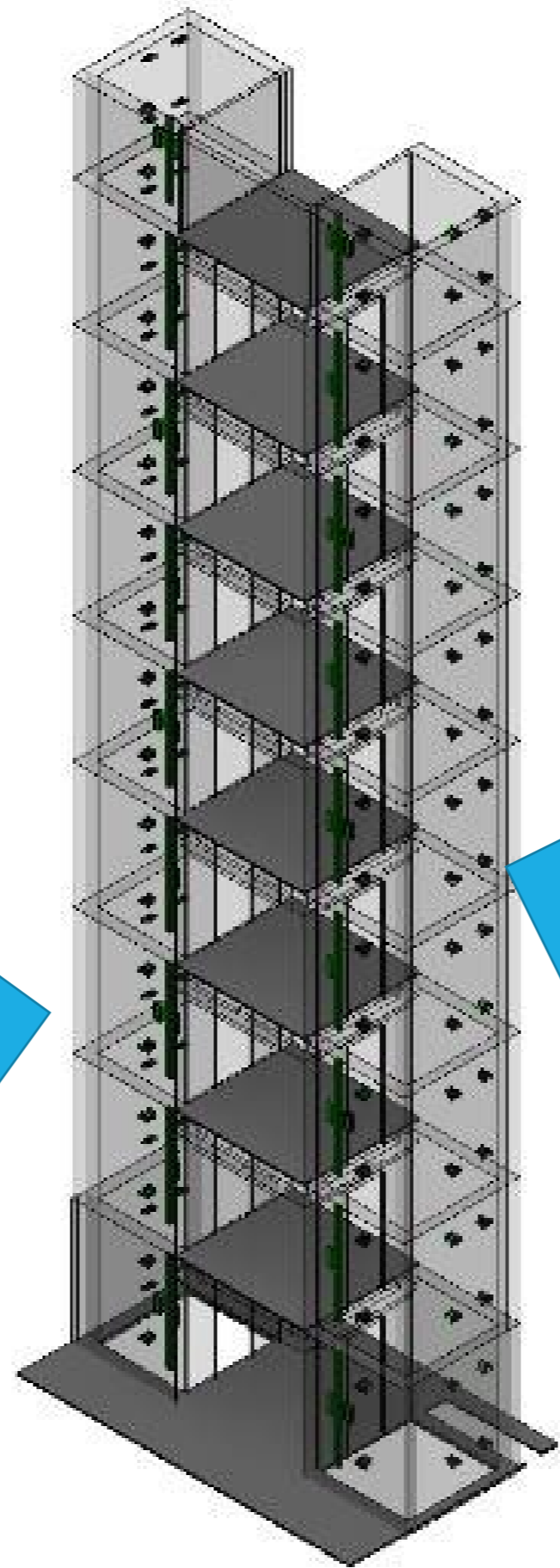
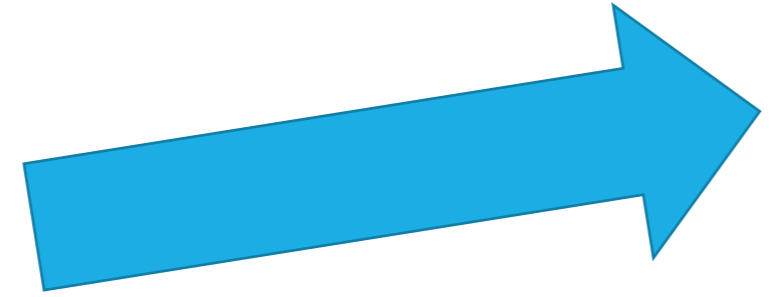
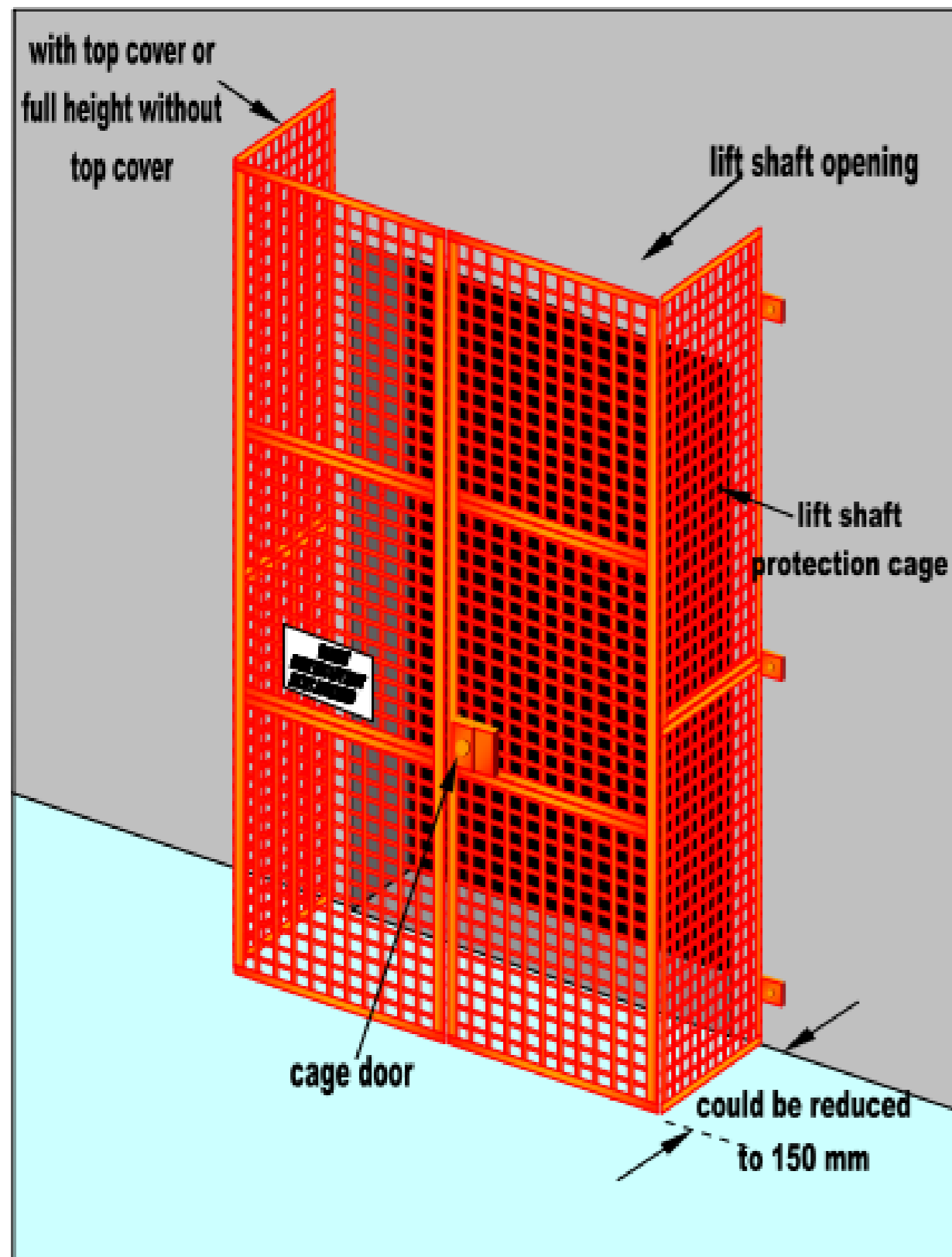

1

DESIGN

2



SHAFT CONSTRUCTION

3

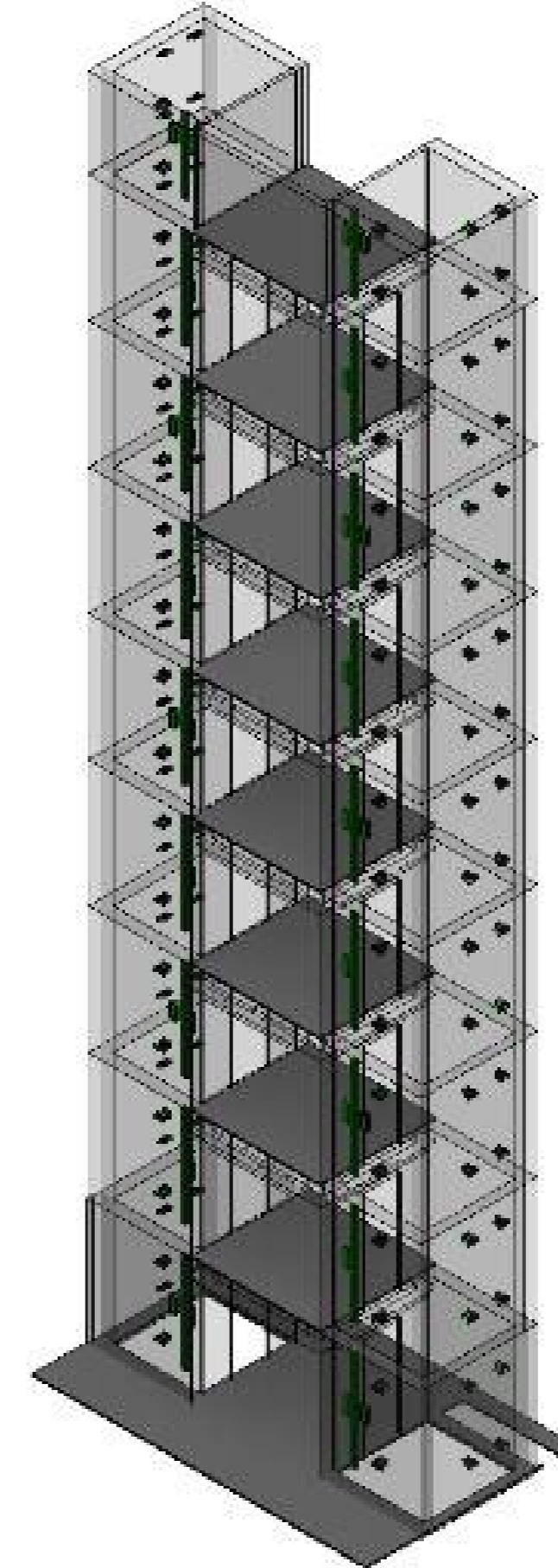
SHAFT EQUIPMENT INSTALLATION

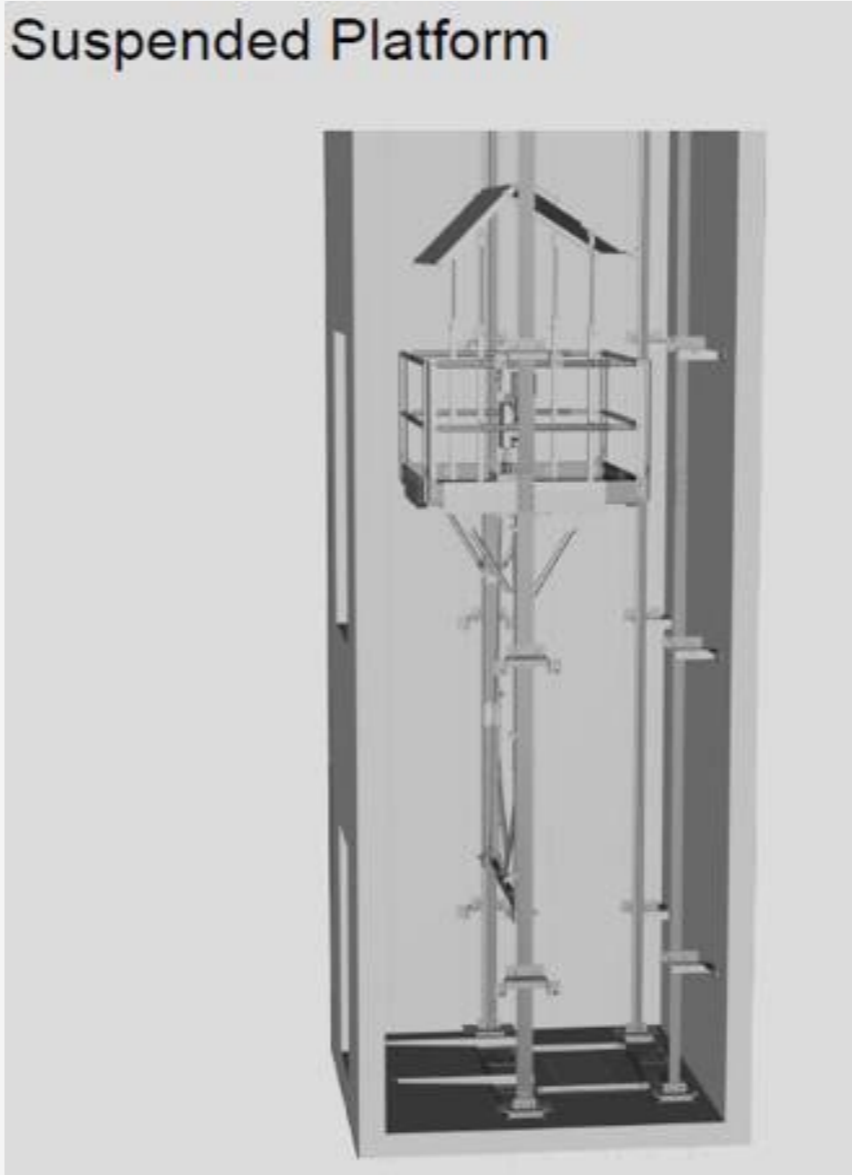

3 ▶ SHAFT EQUIPMENT INSTALLATION

	Traditional (Scaffoldings)	Guided-Suspended Working Platform	Robotic Installation
Installation Method	Scaffoldings	Scaffold-less Lift Installation	Standardized Modular Installation
Special Features	<ul style="list-style-type: none"> - Baseline for Lift Installation 	<ul style="list-style-type: none"> - Flexible - Safety risk arisen from Scaffolding installation can be eliminated 	<ul style="list-style-type: none"> - No Personnel working in lift shaft - Safety, Environmental and Cost benefits
		<p>Suspended Platform</p> 	

- 1 DESIGN
- 2 SHAFT CONSTRUCTION
- 3 SHAFT EQUIPMENT INSTALLATION
- 4 MACHINE ROOM EQUIPMENT INSTALLATION
- 5 CAR CAGE INSTALLATION
- 6 HOISTING ROPES, TRAVELLING CABLES INSTALLATION
- 7 ELECTRICAL INSTALLATION
- 8 TESTING AND COMMISSIONING

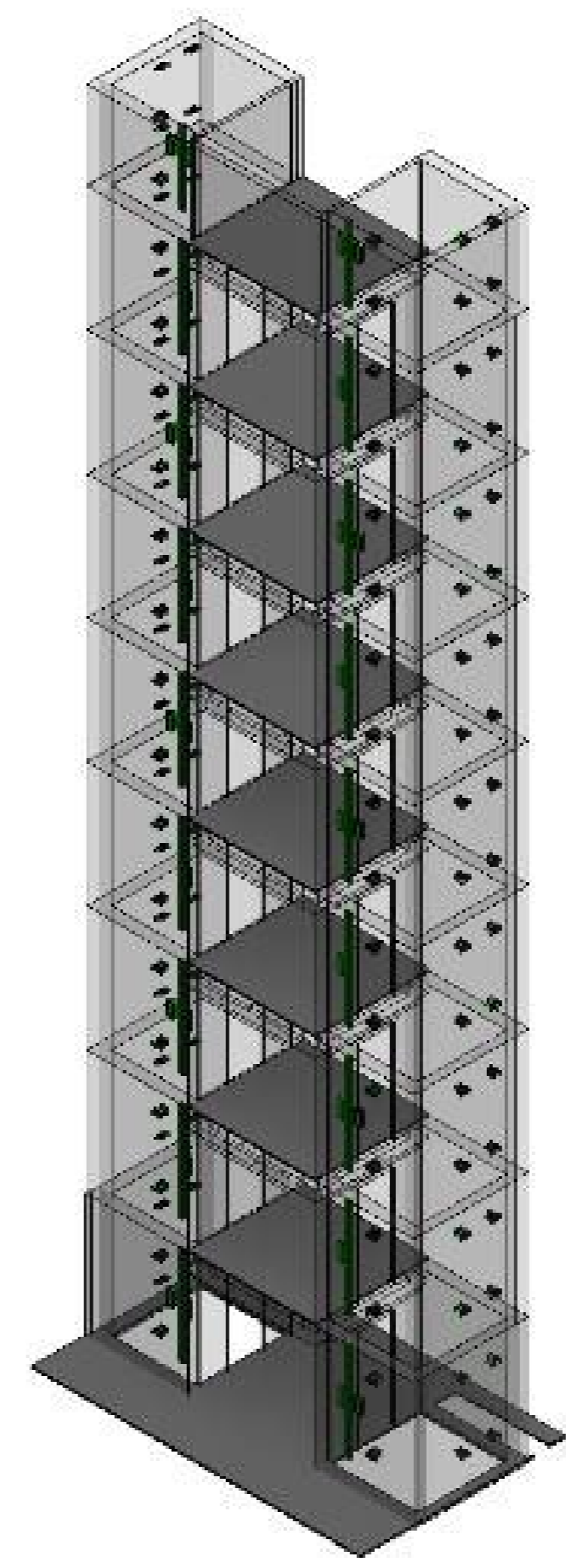

9

MAINTENANCE & REPAIR

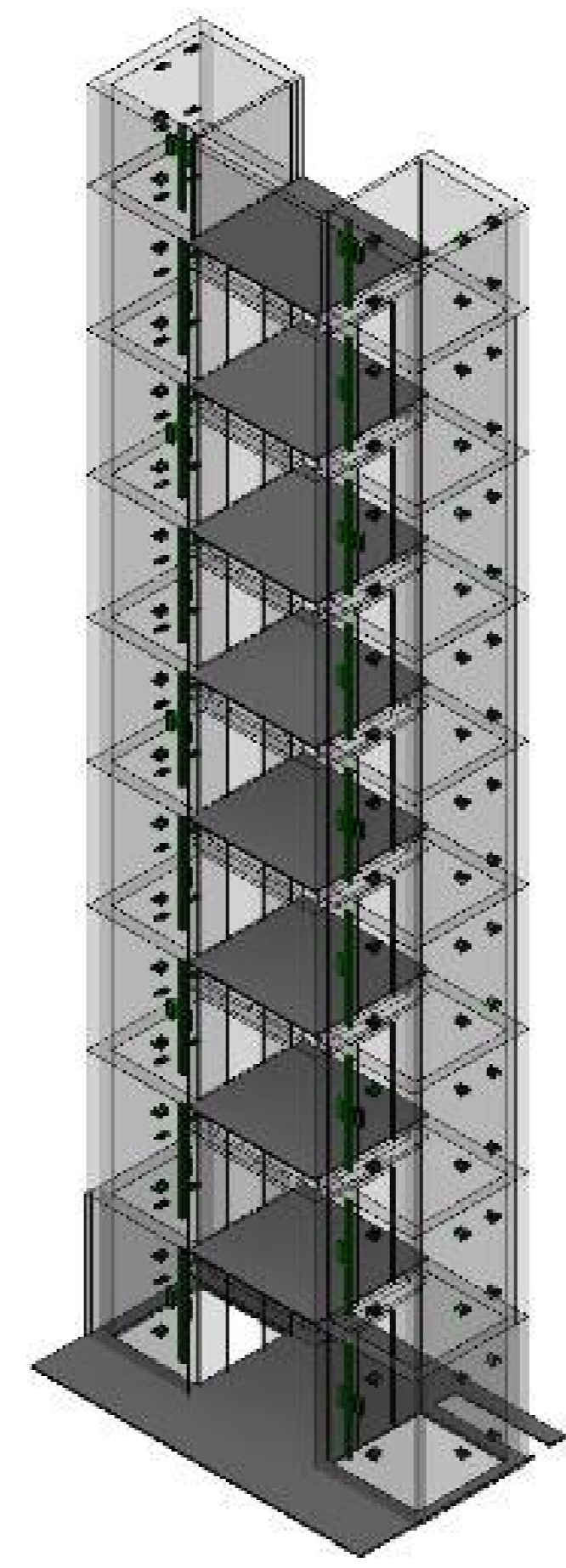



9

MAINTENANCE &
REPAIR

10

MODERNIZATION

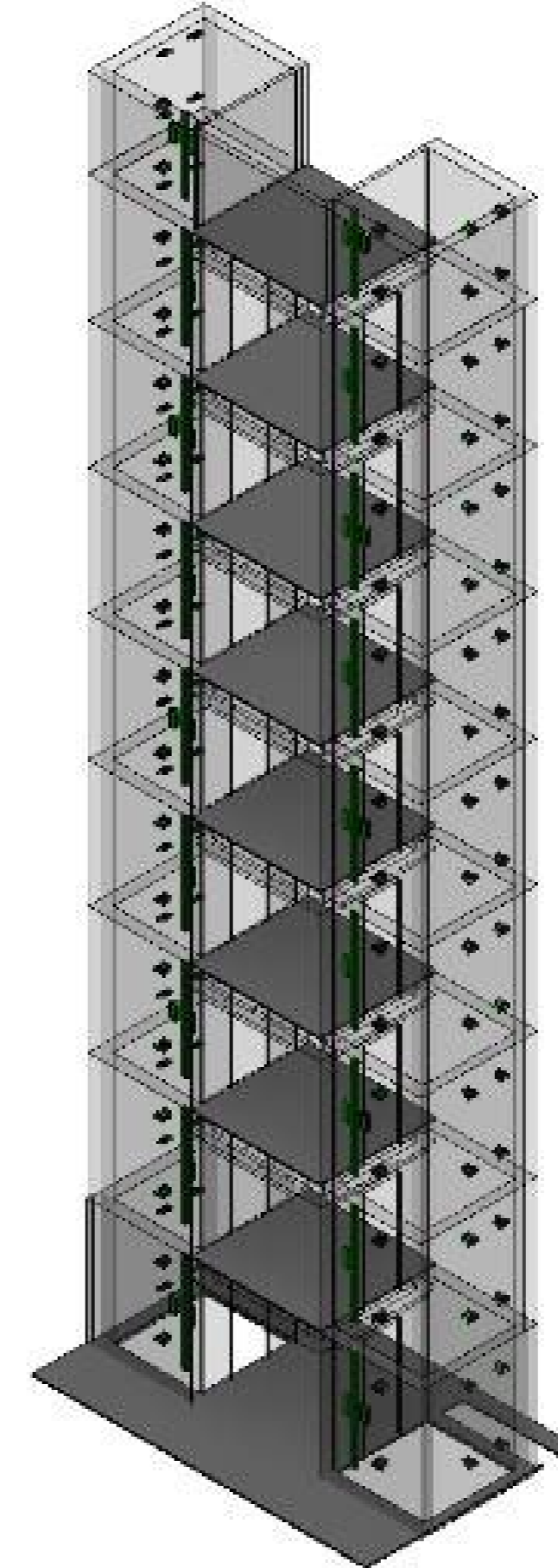

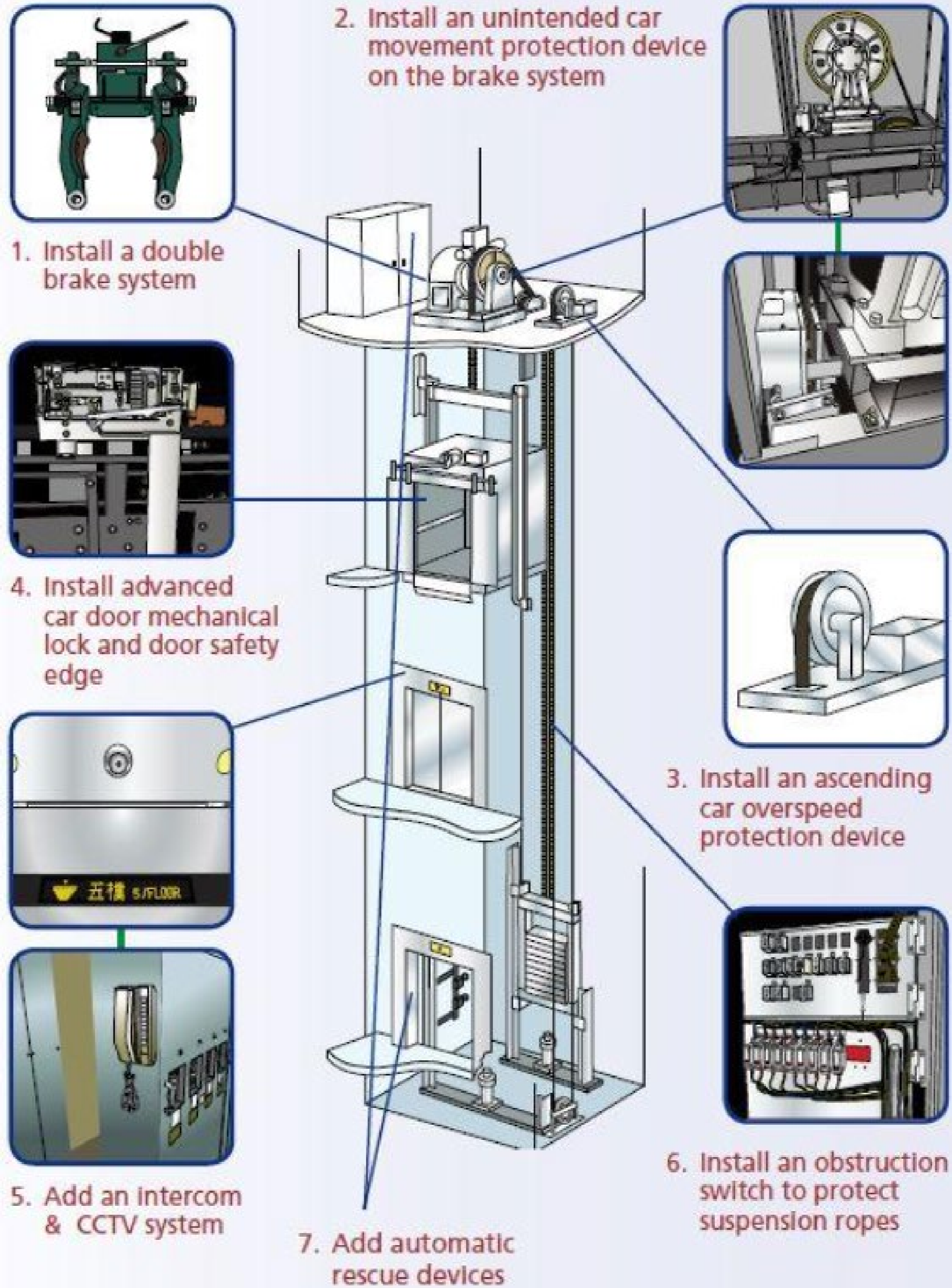

CONTENTS

1 ABOUT US

2 LIFT WORK CYCLE

3 ACCIDENT ANALYSIS

4 SAFE SYSTEM OF WORK &
CARDINAL RULES

5 WHAT ARE WE DOING?





LIFT WORK ACCIDENT ANALYSIS

2021 - 2022

- Installation
- Maintenance
- Others
- Modernization and Repair
- Testing

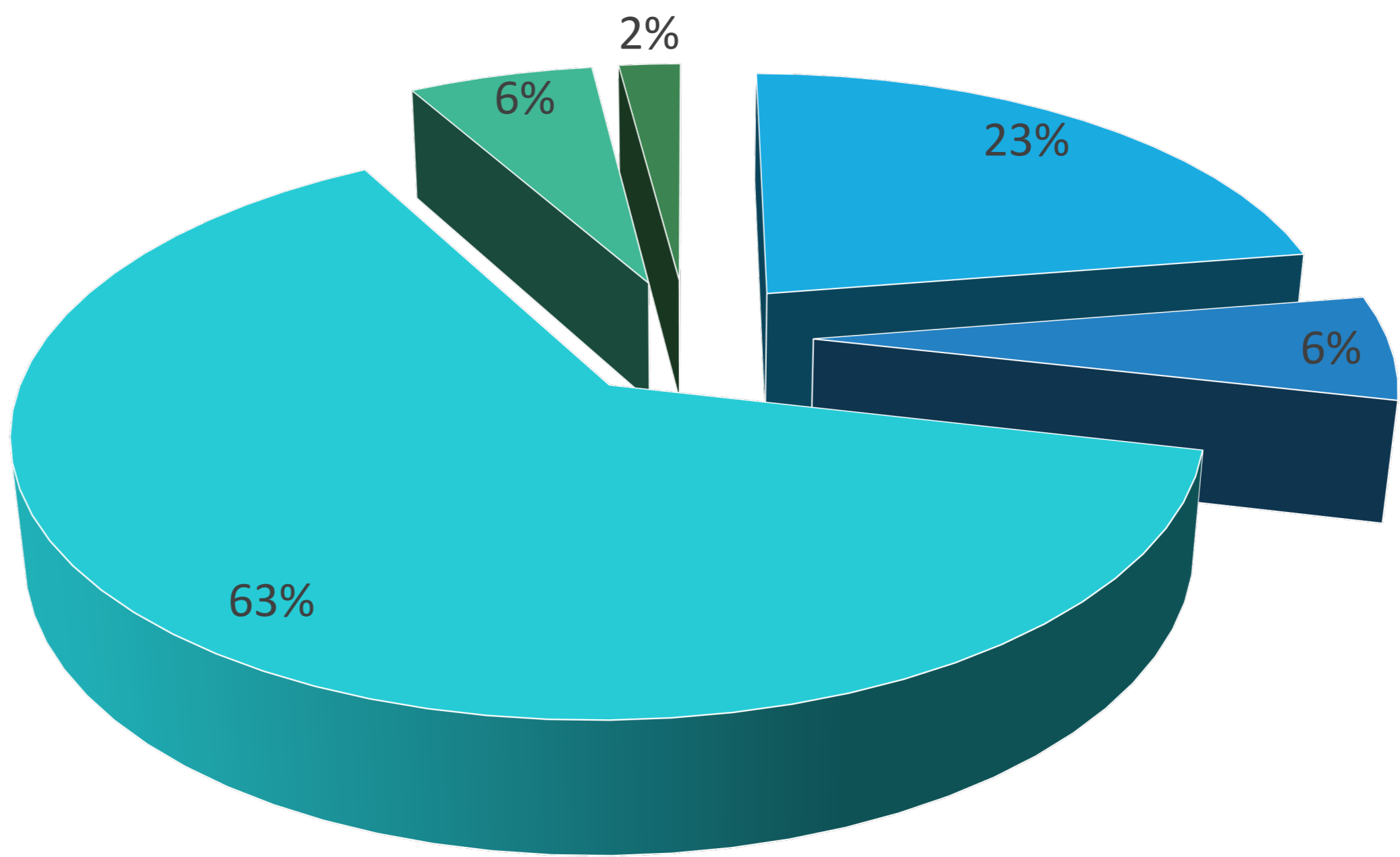

(BASED ON ACCIDENT FIGURES FROM LECA MEMBERS)

LIFT WORK ACCIDENT ANALYSIS

2 0 2 1 - 2 0 2 2

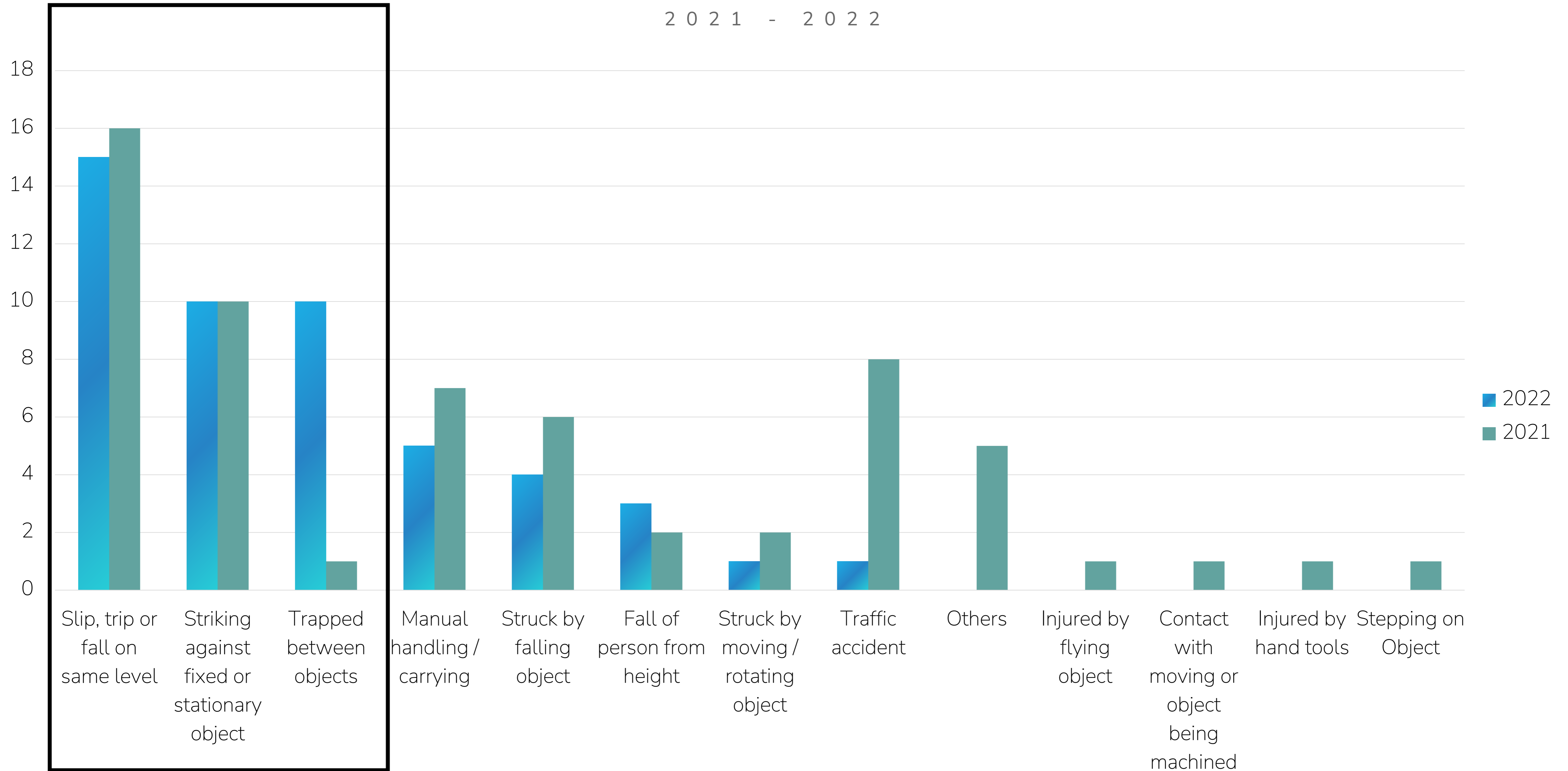

(BASED ON ACCIDENT FIGURES FROM LECA MEMBERS)

CONTENTS

1 ABOUT US

2 LIFT WORK CYCLE

3 ACCIDENT ANALYSIS

4 SAFE SYSTEM OF WORK &
CARDINAL RULES

5 INNOVATIVE SOLUTION

WORK SAFETY IN LIFT SHAFT

SAFE SYSTEM OF WORK

- Incident & Accident investigation & analysis
- Refreshment Training
- Review of SP & SWMS
- Safety promotion & initiative
- Health Insurance
- Continual improvements

- Safety Policies and Safety Plan (SP)
- Safe Working Method Statement (SWMS)
- Kick off meeting
- Competency, awareness and resources
- Risk Assessment
- Emergency preparedness
- Third Parties Employee Safety

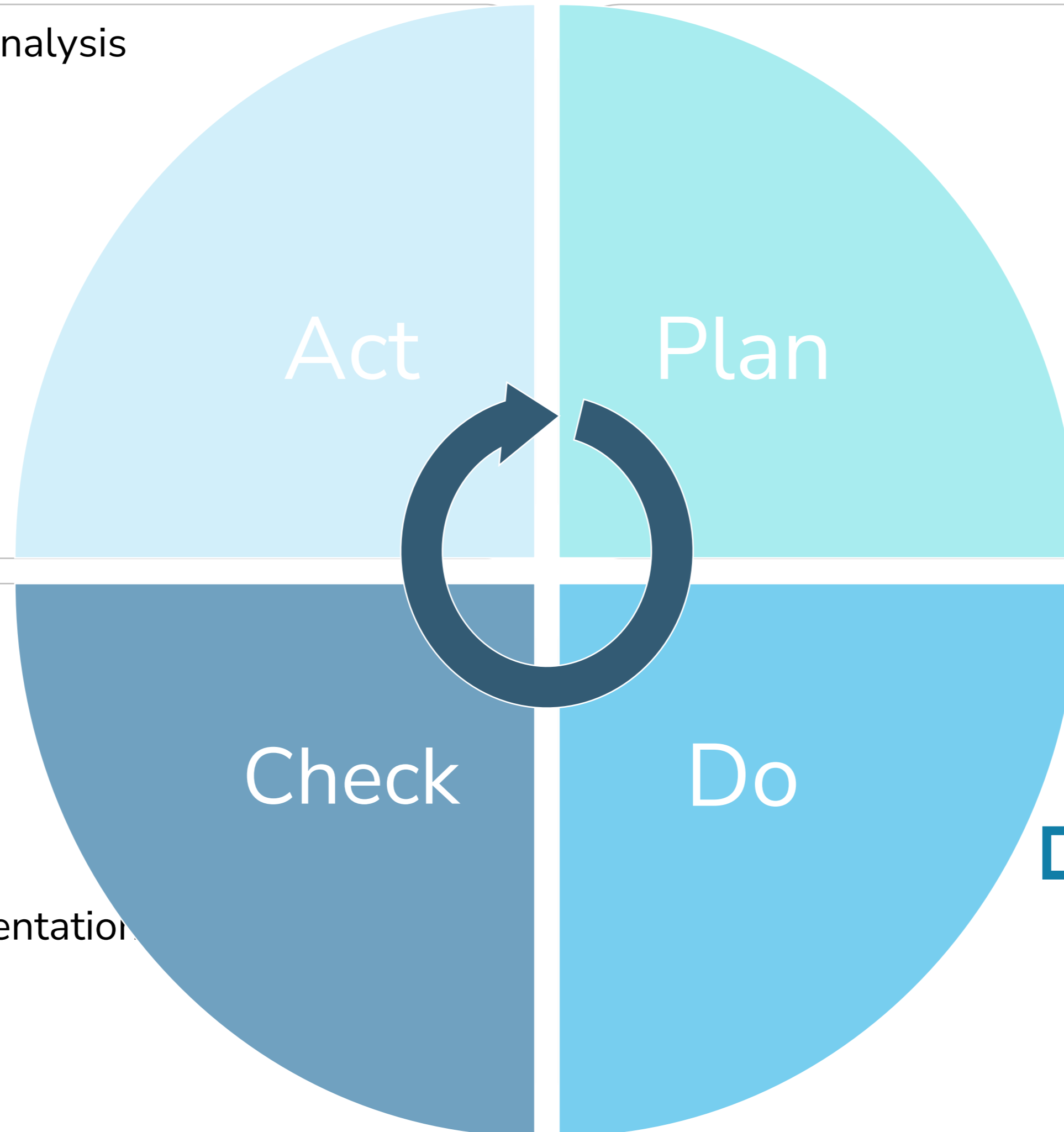

- Safety Inspection
- Direct Supervision
- Morning Briefing
- Permit to Work
- Site safety requirements and documentation
- Safety Audit

- Safety Training
- PPE
- JHA
- Cardinal Rules
- Subcontractor management
- Working tools management

CARDINAL RULES



FALL
PROTECTION



CONTROL OF
HAZARDOUS
ENERGY



SAFE
LIFT SHAFT
ACCESS



SAFE USE
OF JUMPERS



FALL PROTECTION

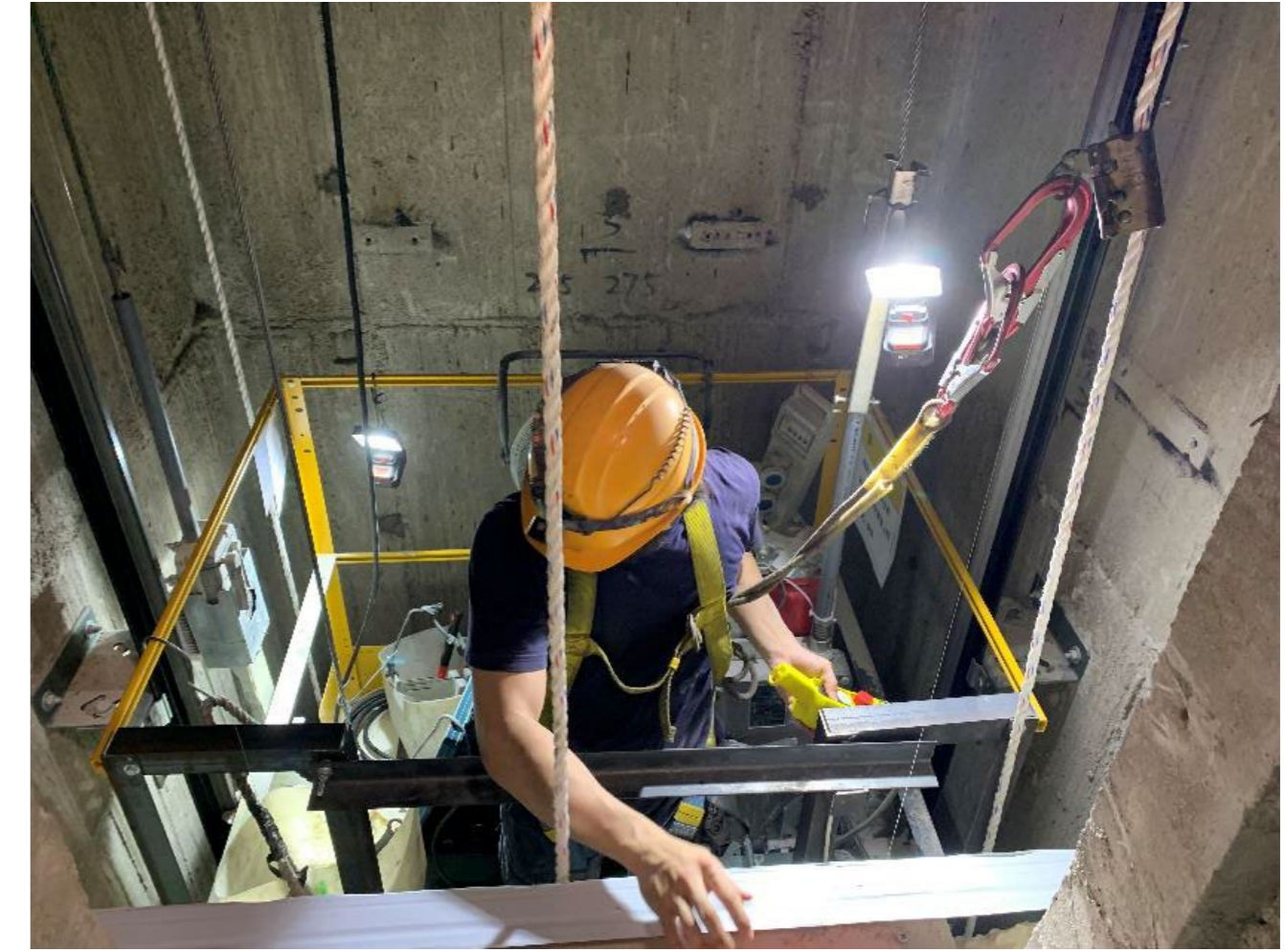

SAFE LIFT SHAFT ACCESS

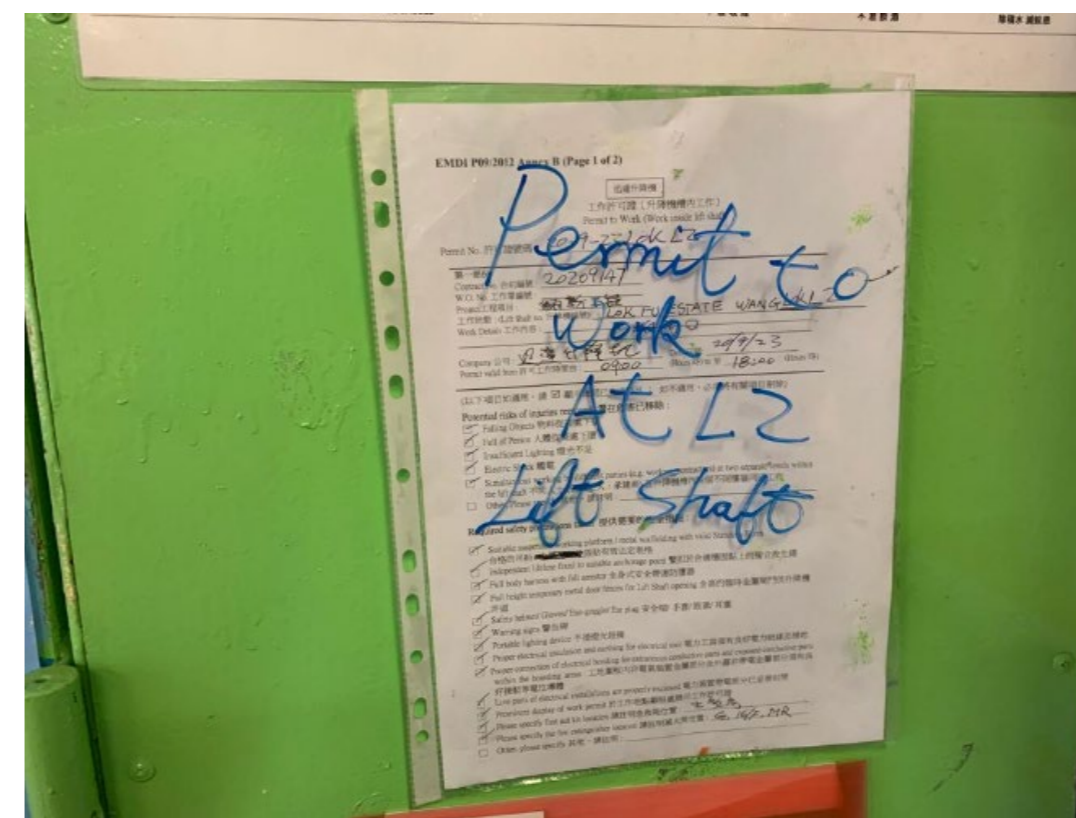



SAFE USE OF JUMPERS



Jardine Schindler

短接線接入及移除記錄

(只適用於中區及中區副中區)

工地名稱: 可樂食廠 機號:

短接線編號	插入短接線者姓名	插入位置	插入日期及時間	移除日期及時間	備註
<u>F50938</u> <u>第一條</u>	<u>李智龍</u>	<u>117 ~ 140</u>	<u>21/5/2021</u>		



CONTROL OF HAZARDOUS ENERGY



CONTENTS

1 ABOUT US

2 LIFT WORK CYCLE

3 ACCIDENT ANALYSIS

4 SAFE SYSTEM OF WORK &
CARDINAL RULES

5 WHAT ARE WE DOING?

INNOVATIVE SOLUTION



INNOVATIVE SOLUTION



CAST-IN CHANNEL



USE OF MIC & MIMEP

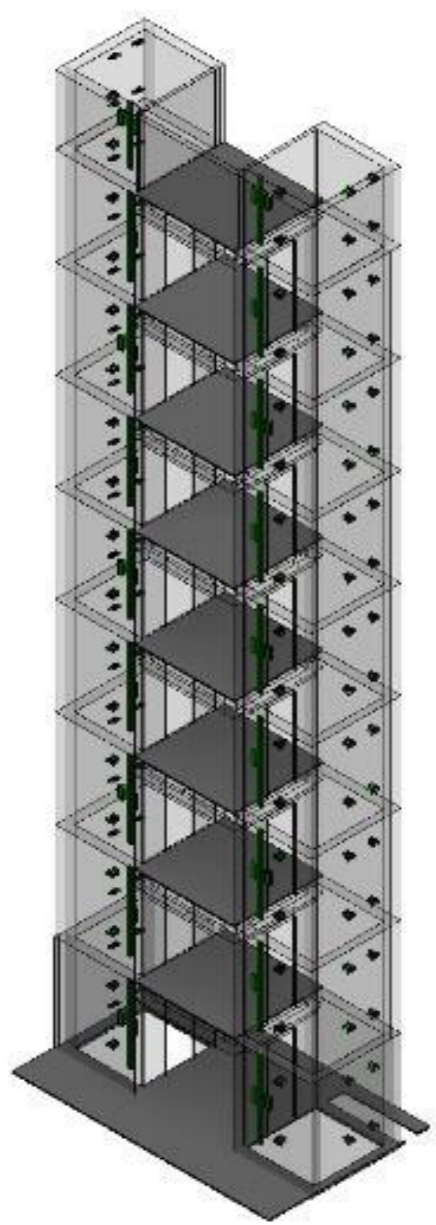

CAR TOP INDICATOR & LIFT PIT BUZZER



警告 WARNING

當閃燈亮著及發出聲響時升降機正在行慢車
請蹲在井底安全位置

When Flashing Light is Illuminated and Buzzer Sounding, this indicates that Lift Car is Moving at Slow Speed. Please take a Squat position at a Safe Area Inside the Lift Pit.

Warning Notice
警告通知

500mm above lift pit level
井底高於 500mm

INNOVATIVE SOLUTION



HEAT STROKE ALARM

MOTION SENSOR

Heat Stroke Alarm

Feature (LED Indicator)



- LED indicator to display real-time heat level
- Provide clear and visible alert for heat stress safety precaution
- Heat level classification in accordance with industrial standard

SMART HELMET



Dasloop IoT Smart Helmet



CONTENTS

1 ABOUT US

2 LIFT WORK CYCLE

3 ACCIDENT ANALYSIS

4 SAFE SYSTEM OF WORK &
CARDINAL RULES

5 WHAT ARE WE DOING?

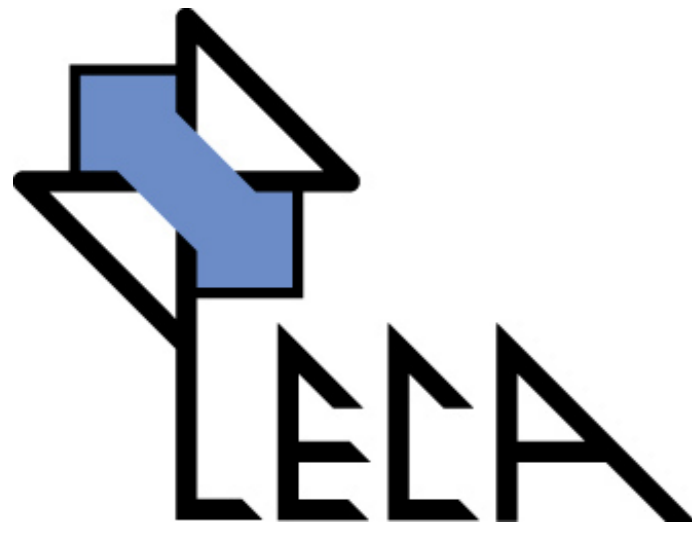

電 梯 業 協 會
**THE LIFT & ESCALATOR
CONTRACTORS ASSOCIATION**

Thank you

