

# **Marble Worker Skilled Trade Test Mock Practical Test Paper**

此文件關於雲石工工藝測試考題。如有需要索取此文件的中文版本，請致電 2100 9232  
與工藝測試中心聯絡。

### **Disclaimer**

*No part of this material may be reproduced or transmitted in any form or any means without the written permission of the CIC. Whilst reasonable efforts have been made to ensure the accuracy of the information contained in this material, the CIC nevertheless would encourage readers to seek appropriate independent advice from their professional advisers where possible and readers should not treat or rely on this material as a substitute for such professional advice for taking any relevant actions.*

### **Enquiries**

Enquiries on this Material may be made to the Trade Test Centre at:

95, Yue Kwong Road  
Aberdeen  
Hong Kong

Tel: (852) 2100 9232  
Fax: (852) 2100 9249  
Email: [enquiry@cic.hk](mailto:enquiry@cic.hk)  
Website: [www.cic.hk](http://www.cic.hk)

## Trade Test Paper

Trade : Marble Worker

Skill Level : Skilled Worker

Question : Complete the following items at the specified location according to the drawings:

1. According to the requirements in Marble Worker Trade Test Shop Drawing 1, fix wall marble:
  - i) Grouting method (wet fixing)
  - ii) Bedding method (wet fixing)
  - iii) Dry hung method (dry fixing)
2. According to the requirements in Marble Worker Trade Test Shop Drawing 2, install marble basin bench top (枱面) and lateral skirting (側身裙條), grind and polish the facing edge (見光邊) of the bench top at the specified location.
3. According to the requirements in Marble Worker Trade Test Shop Drawing 2, lay slab marble and cut drain hole.

Test Time : 7 hours 30 minutes (not including lunch hour)

- Notes:
- (1) The candidate must read the “Notes to Candidates” in the Annex before starting;
  - (2) If the candidate did not complete safety measures during the test, he/she will be deemed to have failed the test; and
  - (3) There are 4 pages in the question. All test items will have a full mark of 100 and 60 marks or above will be considered as pass.

## Marble Worker Trade Test Shop Drawing 1

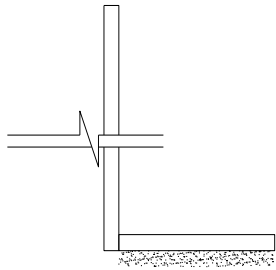

X-X

### Skills requirement

1. All marble surfaces must be vertical and smooth
2. Wet fixing:
  - Grouting method  
Use 1:3 cement mortar to fix  
Make 8mm marble angle
  - Bedding method  
Use 1:1-2 cement mortar to fix
3. Dry fixing:
  - Dry hung method  
Fix with stainless steel angle plate bracket and up & down folded bracket, secure with marble glue

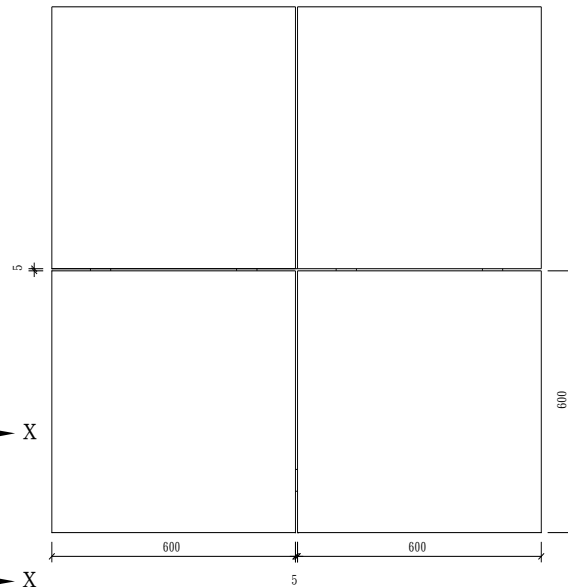
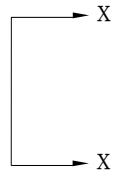

Dry Hung Method (Dry Fixing)

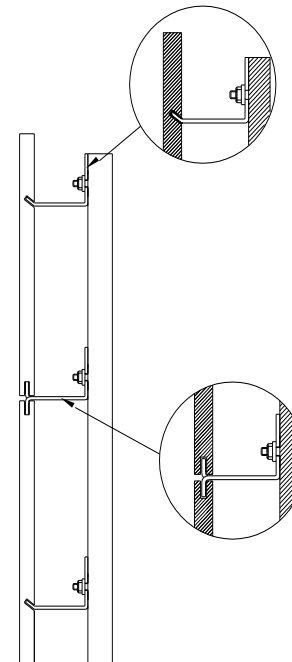

Side Elevation

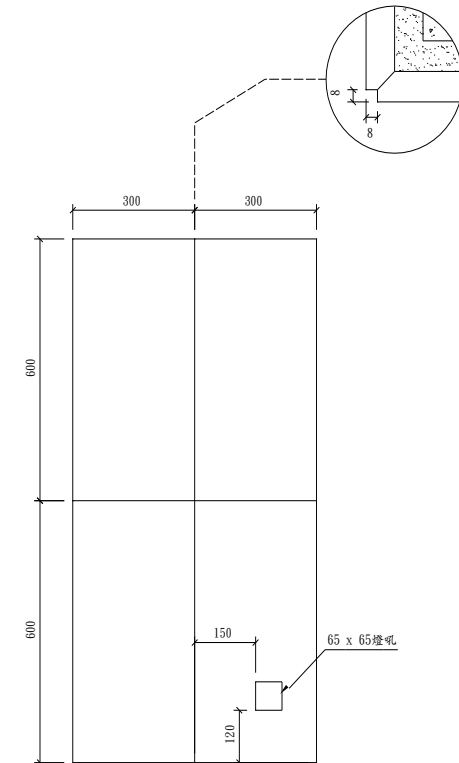

Wet Fixing

Drawing not in proportion

Measurements in mm

## Marble Worker Trade Test Shop Drawing 2

### Skills requirement:

1. The surfaces of all marbles fixed must be vertical and smooth

2. Basin:

- Bench top  
Pave with 1:3 half-dry sand
- Skirting  
Fix with 1:1-2 cement mortar

Align with the side of the bench to complete

Grind and polish the facing edge

3. Floor slab:

- Half-dry mortar method  
Pave with 1:3 half dry sand
- Drain hole  
Measure and cut according to on-site position  
Level according to the drain hole to complete

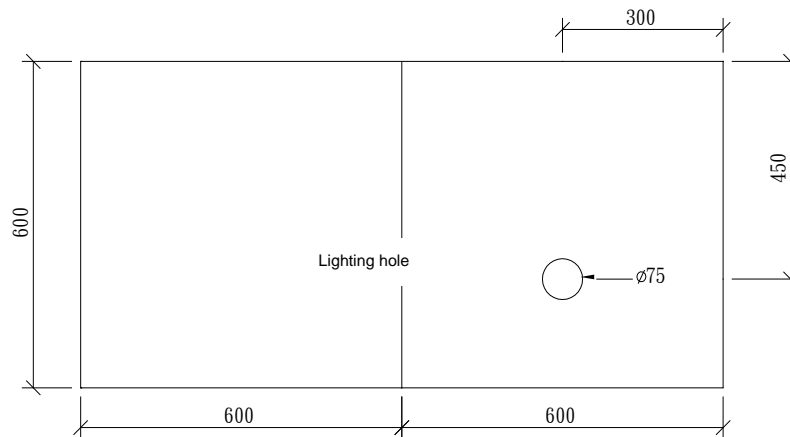

Floor Slab Plan

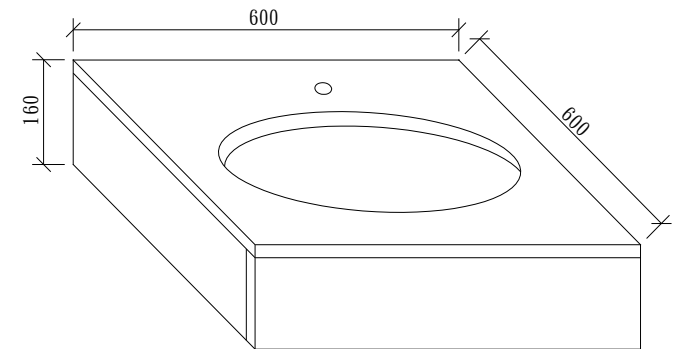

Basin Bench Top 3-D Plan

Drawing not in proportion

Measurements in mm

## Notes to Candidates :

1. Candidates should read the test papers carefully and ask the invigilator for any queries.
2. Candidates should study the drawings and specifications attached to test papers, if any, before the test begins.
3. Candidates should carry out the test according to test papers, working drawings and specifications provided.
4. Candidates shall bring their own safety shoes, other safety equipment will be provided by trade testing centre. Candidates must take all necessary safety precautions to ensure work safety.
5. All tools and materials required by the test will be provided by trade testing centre, candidates should check and ensure their adequacy and quality. Candidates shall use the tools and materials properly based on trade practice. All the tools must be returned to trade testing centre after the test. The candidates may ask the invigilator for any problems.
6. Candidates are required to handle and move the tools and materials for use in the test, and to carry out associated works.
7. Invigilator will take record photos periodically during the test.
8. Candidates are not allowed to take any photo or video with cameras or mobile phones.
9. Candidates are not allowed to use their mobile phones during the trade tests, except for emergency situation.
10. The marking scheme is based on the following criteria :
  - a) Understanding of drawing and specification

- b) Preparation works before commencement of test
- c) Working procedures
- d) Accuracy and quality of works
- e) Progress of works
- f) Proper handling and use of materials
- g) Proper use of tools and equipment
- h) Safety precautions
- i) Considerate of other trades
- h) Housekeeping after completion of test

- 11. All candidates must stop when time is up.
- 12. Candidates are required to return the test paper to invigilator after the test.
- 13. Offering bribe to invigilator is an offence in law and trade testing centre will report to the ICAC for any such case.

<p><b>In the event that the candidate fails to take any necessary safety precautions and / or works in any dangerous situations, he / she will be assessed failed</b></p>
---